

Actuator

46-
2J31.15T0.000

Distribution by
Mouser



<https://mouser.eao.com/component/46-2J31.15T0...>

Your product:



46-2J31.15T0.000 Actuator

Loading ...

FRONT

Front dimension:	58 mm x 29 mm
Front form:	Rectangular
Front bezel colour:	Black
Front bezel material:	Plastic

MOUNTING

Design:	Raised
Mounting cut-out:	Ø 22.3 mm
Mounting type:	Panel mounting

OPERATING-/INDICATION PART

Lens colour:	Green-red
Lens material:	Plastic
Lens illumination:	Non illuminated
Lens shape:	Flush
Lens optics:	opaque
Lens type:	Level with front bezel

ELECTRICAL CHARACTERISTICS

Protection class:	II
--------------------------	----

MECHANICAL CHARACTERISTICS

Switching action: Momentary
Mechanical lifetime: 1 Mil. cycles of operation
Tightening torque: 2 ... 3 Nm (17.7 ... 26.6 Lb-in)
Weight: 0.025 kg

AMBIENT CONDITION

IP front protection: IP65
IK front protection: IK03
Operating temperature: - 25 °C ... + 55 °C
Shock resistance: 30g, 18ms (EN-IEC 60068-2-27)
50g, 11ms (EN-IEC 60068-2-27)
Vibration resistance: 5g f= 2...500Hz (EN-IEC 60068-2-6)
Climate resistance: +25°C-97%RH / +45°C-93%RH (IEC-EN60068-2-30)

CERTIFICATE

Approbations: CSA, EAC, UL
Conformities: CE
REACH: REACH compliant
RoHS: RoHS compliant
Standards: CSA C22-2, IEC EN 60947-1, IEC EN 60947-5-1, UL508

OTHER

Short Description: Actuator, Ø 22.3 mm, 58 mm x 29 mm, Flush, Non illuminated, Green-red, Plastic, opaque, Rectangular, Black, Plastic, Momentary, IP65, IK03
Housing colour: Black
Housing material: Plastic
max. number of switching elements: 8
Mounting cut-outs:

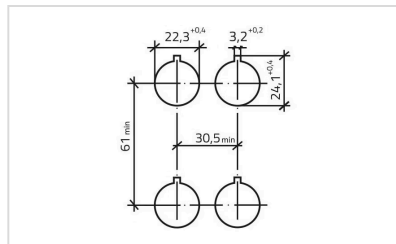

Dimension drawings:

