

PCB plug-in base

61-9823

Distribution by
Mouser



<https://mouser.eao.com/component/61-9823/en/p...>

Your product:



61-9823 PCB plug-in base

Loading ...

ELECTRICAL CHARACTERISTICS

Forward voltage:

MECHANICAL CHARACTERISTICS

Terminal: PCB terminal

Weight: 0.002 kg

OTHER

Short Description: PCB plug-in base, PCB terminal, Axial

Titel Accessory: PCB plug-in base

Product attributes: For slow-make switching element

Pins: Axial

Component layouts:

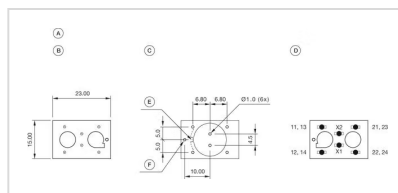

A = PCB plug-in base
B = Terminals (rear side)
C = Drilling plan (component side)
D = Occupancy plan (component side)
E = Anti-rotation device
F = Positioning hole

Dimension drawings:

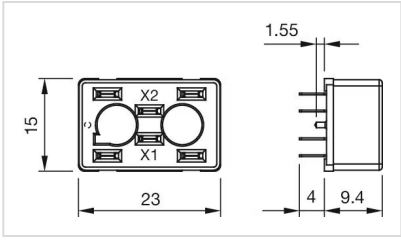

For Part No. 61-9823