

# Illuminated pushbutton Ø 19 mm silver contact

82-5151.2124.B002

Distribution by  
Mouser



<https://mouser.eao.com/p/82-5151.2124.B002>

Your product:

---



82-5151.2124.B002  
Illuminated pushbutton Ø  
19 mm silver contact

#### FRONT

|                       |                 |
|-----------------------|-----------------|
| Front dimension:      | Ø 22 mm         |
| Front form:           | Round           |
| Front bezel material: | Stainless steel |
| Front bezel shape:    | Flush           |

#### MOUNTING

|                   |                |
|-------------------|----------------|
| Mounting cut-out: | Ø 19 mm        |
| Mounting type:    | Panel mounting |

#### OPERATING-/INDICATION PART

|                        |                 |
|------------------------|-----------------|
| Lens colour:           | Silver          |
| Lens material:         | Stainless steel |
| Lens illumination:     | Illuminated     |
| Lens shape:            | Flush           |
| Lens optics:           | opaque          |
| Symbol:                | Standby         |
| Illumination colour:   | Blue            |
| Shape of illumination: | Ring            |

#### ELECTRICAL CHARACTERISTICS

Switching voltage and switching  
current:

|  |                     |
|--|---------------------|
| according to IEC 60947-5-1 (Silver contacts)               |                     |
| Service categorie AC-15                                    |                     |
| Voltage  | Current             |
| 24 VAC   | 1 A                 |
| 35 VAC   | 1 A (M12 version)   |
| 110 VAC  | 1 A                 |
| 220 VAC  | 0.5 A               |
| Switch rating DC service categorie DC-13 (Silver contacts) |                     |
| Voltage  | Current             |
| 24 VDC   | 0.7 A               |
| 35 VDC   | 0.5 A (M12 version) |
| 110 VDC  | 0.2 A               |
| 220 VDC  | 0.1 A               |

|                                       |         |
|---------------------------------------|---------|
| according to UL 508 (Silver contacts) |         |
| cosφ 0,75 ... 0,8                     |         |
| Voltage                               | Current |
| 120 VAC                               | 5 A     |
| 240 VAC                               | 3 A     |
| 24 VAC                                | 1 A     |

|                                      |  |
|--------------------------------------|--|
| <b>Contacts:</b>                     | 1 C  |
| <b>Operating voltage:</b>            | 24 V DC  |
| <b>Operation current:</b>            | 7 mA   |
| <b>Rated Operational Voltage Ue:</b> | 250 VAC  |
| <b>Rated insulation voltage Ui:</b>  | 250 V  |
| <b>Switching rating:</b>             | 240 V  |
| <b>Electrical lifetime:</b>          | 50 000 cycles of operation                                 |
| <b>Electric strength:</b>            | 1500 VAC, 50 Hz 1 minute between life terminals and ground |
| <b>Pollution degree:</b>             | 2, according to EN IEC 60947-1                             |
| <b>Thermal current Ith:</b>          | 5 A  |

## MECHANICAL CHARATERISTIC

|                             |                                  |
|-----------------------------|----------------------------------|
| <b>Terminal:</b>            | Soldering terminal, 2.8 x 0.5 mm |
| <b>Contact material:</b>    | Silver                           |
| <b>Switching action:</b>    | Maintained                       |
| <b>Switching system:</b>    | Snap-action switching element    |
| <b>Mechanical lifetime:</b> | 500 000 cycles of operation      |
| <b>Operating force:</b>     | 4 N ... 7 N                      |
| <b>Operating Travel:</b>    | ca. 3 mm                         |
| <b>Tightening torque:</b>   | 0.5 ... 0.6 Nm                   |
| <b>Weight:</b>              | 0.018 kg                         |

## AMBIENT CONDITION

|                               |  |
|-------------------------------|--|
| <b>IP front protection:</b>   | IP65, IP67   |
| <b>Operating temperature:</b> | – 30 °C ... + 70 °C  |
| <b>Storage temperature:</b>   | – 40 °C ... + 80 °C  |
| <b>Shock resistance:</b>      | Max. 500 m / s <sup>2</sup> as per IEC 60068-2-27              |
| <b>Vibration resistance:</b>  | 10 ... 500 Hz, amplitude 1.5 mm p-p according to IEC 60068-2-6 |
| <b>Climate resistance:</b>    | Damp heat, 21 days according to IEC 60512-11                   |

## CERTIFICATE

|                      |   |
|----------------------|---|
| <b>Approbations:</b> | CB, CCC, C UL, UL                               |
| <b>Conformities:</b> | CE, 2011 / 65 / EC (RoHS), 2014 / 35 / EU (LVD) |
| <b>REACH:</b>        | REACH compliant                                 |
| <b>RoHS:</b>         | RoHS compliant                                  |

## OTHER

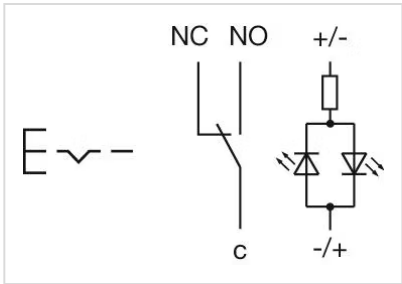
|                              |  |
|------------------------------|--|
| <b>Short Description:</b>    | Illuminated pushbutton Ø 19 mm silver contact, Maintained, 240 V , 24 V DC, 1 C, Soldering terminal, 2.8 x 0.5 mm, Round, Stainless steel, Blue, Standby, Silver |
| <b>Kind of illumination:</b> | Single-LED   |
| <b>Wiring diagrams:</b>      |    |

## Component layouts:

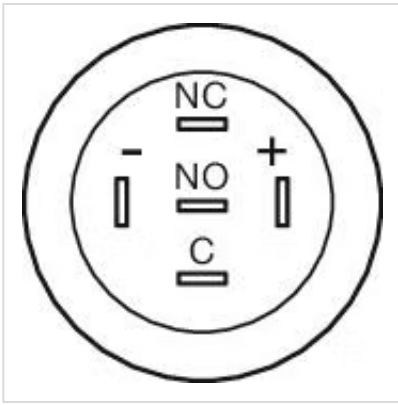

**Mounting cut-outs:**

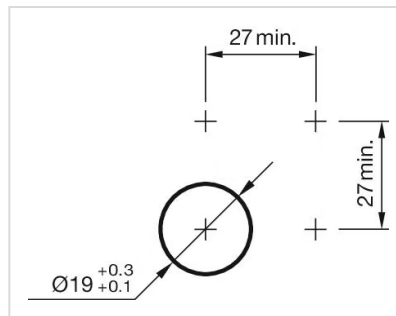

**Dimension drawings:**

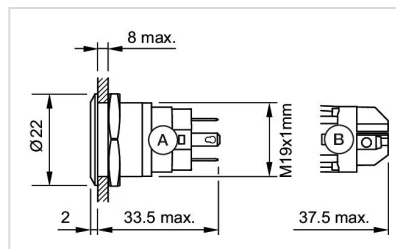

A = Solder terminal  
B = Screw terminal