

# Push button Ø 19 mm silver contact

82-5552.1000

Distribution by  
Mouser



<https://mouser.eao.com/component/82-5552.1000...>

Your product:

---



82-5552.1000

Push button Ø 19 mm silver contact

*Loading . . .*

#### FRONT

**Front dimension:** Ø 22 mm

**Front form:** Round

**Front bezel material:** Aluminium

**Front bezel shape:** Flush

#### MOUNTING

**Mounting cut-out:** Ø 19 mm

**Mounting type:** Panel mounting

#### OPERATING-/INDICATION PART

**Lens colour:** Nature

**Lens material:** Aluminium

**Lens illumination:** Non illuminated

**Lens shape:** Flush

**Lens optics:** opaque

#### ELECTRICAL CHARACTERISTICS

**Switching voltage and switching current:**

|  |                     |
|--|---------------------|
| according to IEC 60947-5-1 (Silver contacts)               |                     |
| Service categorie AC-15                                    |                     |
| Voltage  | Current             |
| 24 VAC   | 1 A                 |
| 35 VAC   | 1 A (M12 version)   |
| 110 VAC  | 1 A                 |
| 220 VAC  | 0.5 A               |
| Switch rating DC service categorie DC-13 (Silver contacts) |                     |
| Voltage  | Current             |
| 24 VDC   | 0.7 A               |
| 35 VDC   | 0.5 A (M12 version) |
| 110 VDC  | 0.2 A               |
| 220 VDC  | 0.1 A               |

|                                       |         |
|---------------------------------------|---------|
| according to UL 508 (Silver contacts) |         |
| cosφ 0,75 ... 0,8                     |         |
| Voltage                               | Current |
| 120 VAC                               | 5 A     |
| 240 VAC                               | 3 A     |
| 24 VAC                                | 1 A     |

|                                      |  |
|--------------------------------------|--|
| <b>Contacts:</b>                     | 1 C  |
| <b>Rated Operational Voltage Ue:</b> | 250 VAC  |
| <b>Rated insulation voltage Ui:</b>  | 250 V  |
| <b>Switching rating:</b>             | 240 V  |
| <b>Electrical lifetime:</b>          | 50 000 cycles of operation                                 |
| <b>Electric strength:</b>            | 1500 VAC, 50 Hz 1 minute between life terminals and ground |
| <b>Pollution degree:</b>             | 2, according to EN IEC 60947-1                             |
| <b>Thermal current Ith:</b>          | 5 A  |

## MECHANICAL CHARACTERISTICS

|                             |                                       |
|-----------------------------|---------------------------------------|
| <b>Terminal:</b>            | Screw terminal                        |
| <b>Contact material:</b>    | Silver                                |
| <b>Switching action:</b>    | Momentary                             |
| <b>Switching system:</b>    | Snap-action switching element         |
| <b>Mechanical lifetime:</b> | 1 Mil. cycles of operation (RCC/RPB)  |
| <b>Operating force:</b>     | 4 N ... 7 N                           |
| <b>Operating Travel:</b>    | ca. 3 mm                              |
| <b>Tightening torque:</b>   | 0.5 ... 0.6 Nm, Screw terminal 0.1 Nm |
| <b>Weight:</b>              | 0.018 kg                              |

## AMBIENT CONDITION

|                             |  |
|-----------------------------|--|
| <b>IP front protection:</b> |  |
|-----------------------------|--|

IP65, IP67

**Operating temperature:**

– 30 °C ... + 70 °C

**Storage temperature:**

– 40 °C ... + 80 °C

**Shock resistance:**

Max. 500 m / s<sup>2</sup> as per IEC 60068-2-27

**Vibration resistance:**

10 ... 500 Hz, amplitude 1.5 mm p-p according to IEC 60068-2-6

**Climate resistance:**

Damp heat, 21 days according to IEC 60512-11

**CERTIFICATE**

**Approbations:**

CB, CCC, C UL, UL

**Conformities:**

CE, 2011 / 65 / EC (RoHS), 2014 / 35 / EU (LVD)

**REACH:**

REACH compliant

**RoHS:**

RoHS compliant

**OTHER**

**Short Description:**

Push button Ø 19 mm silver contact, Momentary, 240 V, 1 C, Screw terminal, Round, Aluminium, Nature

**Wiring diagrams:**

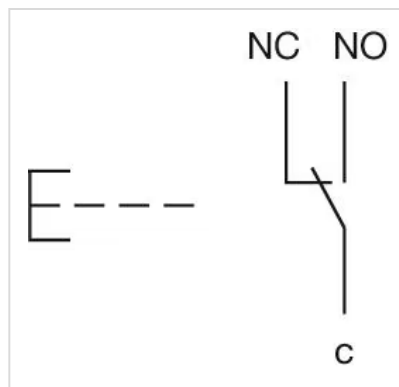

**Component layouts:**

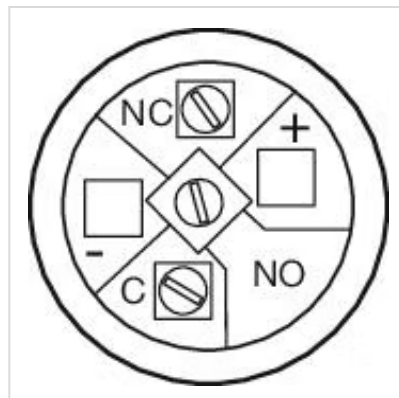

### Mounting cut-outs:

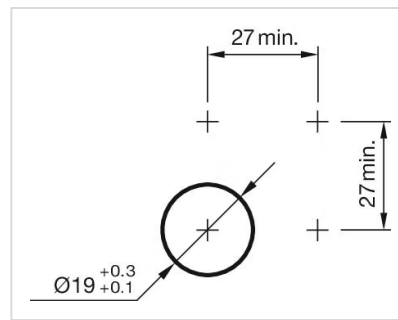

### Dimension drawings:

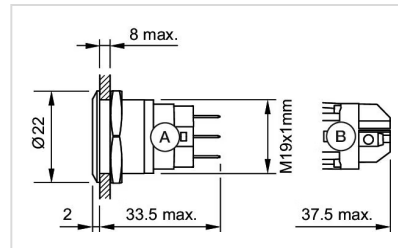

A = Solder terminal  
B = Screw terminal