

Push button Ø  
22 mm silver contact

Distribution by  
Mouser



82-6151.2000.B001



<https://mouser.eao.com/component/82-6151.2000...>

Your product:

---



82-6151.2000.B001  
Push button Ø 22 mm silver contact

#### FRONT

|                              |                 |
|------------------------------|-----------------|
| <b>Front dimension:</b>      | Ø 25 mm         |
| <b>Front form:</b>           | Round           |
| <b>Front bezel material:</b> | Stainless steel |
| <b>Front bezel shape:</b>    | Flush           |

#### MOUNTING

|                          |                |
|--------------------------|----------------|
| <b>Mounting cut-out:</b> | Ø 22 mm        |
| <b>Mounting type:</b>    | Panel mounting |

#### OPERATING-/INDICATION PART

|                           |                 |
|---------------------------|-----------------|
| <b>Lens colour:</b>       | Silver          |
| <b>Lens material:</b>     | Stainless steel |
| <b>Lens illumination:</b> | Non illuminated |
| <b>Lens shape:</b>        | Flush           |
| <b>Lens optics:</b>       | opaque          |
| <b>Symbol:</b>            | ON/OFF          |

#### ELECTRICAL CHARACTERISTICS

**Switching voltage and switching current:**

according to IEC 60947-5-1 (Silver contacts)

Service categorie AC-15

Voltage

24 VAC

35 VAC

110 VAC

220 VAC

Current

1 A

1 A (M12 version)

1 A

0.5 A

Switch rating DC service categorie DC-13 (Silver contacts)

Voltage

24 VDC

35 VDC

110 VDC

220 VDC

Current

0.7 A

0.5 A (M12 version)

0.2 A

0.1 A

according to UL 508 (Silver contacts)

$\cos\phi$  0,75 ... 0,8

Voltage

120 VAC

240 VAC

24 VAC

Current

5 A

3 A

1 A

|  |  |
|--|--|
| <b>Contacts:</b>                       | 1 C  |
| <b>Switching rating:</b>               | 240 V  |
| <b>Electrical lifetime:</b>            | 50 000 cycles of operation                                 |
| <b>Electric strength:</b>              | 1500 VAC, 50 Hz 1 minute between life terminals and ground |
| <b>Pollution degree:</b>               | 2, according to EN IEC 60947-1                             |
| <b>Thermal current I<sub>th</sub>:</b> | 5 A  |

## MECHANICAL CHARACTERISTICS

|                             |                                  |
|-----------------------------|----------------------------------|
| <b>Terminal:</b>            | Soldering terminal, 2.8 x 0.5 mm |
| <b>Contact material:</b>    | Silver                           |
| <b>Switching action:</b>    | Maintained                       |
| <b>Switching system:</b>    | Snap-action switching element    |
| <b>Mechanical lifetime:</b> | 500 000 cycles of operation      |
| <b>Operating force:</b>     | 4 N ... 7 N                      |
| <b>Operating Travel:</b>    | ca. 3 mm                         |
| <b>Tightening torque:</b>   | 0.5 ... 0.6 Nm                   |
| <b>Weight:</b>              | 0.018 kg                         |

## AMBIENT CONDITION

|                               |                     |
|-------------------------------|---------------------|
| <b>IP front protection:</b>   | IP65, IP67          |
| <b>Operating temperature:</b> | - 30 °C ... + 70 °C |
| <b>Storage temperature:</b>   |                     |

- 40 °C ... + 80 °C

**Shock resistance:**

Max. 500 m / s<sup>2</sup> as per IEC 60068-2-27

**Vibration resistance:**

10 ... 500 Hz, amplitude 1.5 mm p-p according to IEC 60068-2-6

**Climate resistance:**

Damp heat, 21 days according to IEC 60512-11

**CERTIFICATE**

**Conformities:**

CE, 2011 / 65 / EC (RoHS), 2014 / 35 / EU (LVD)

**REACH:**

REACH compliant

**RoHS:**

RoHS compliant

**OTHER**

**Short Description:**

Push button Ø 22 mm silver contact, Maintained, 240 V, 1 C, Soldering terminal, 2.8 x 0.5 mm, Round, Stainless steel, ON/OFF, Silver

**Housing size:**

19 mm

**Wiring diagrams:**

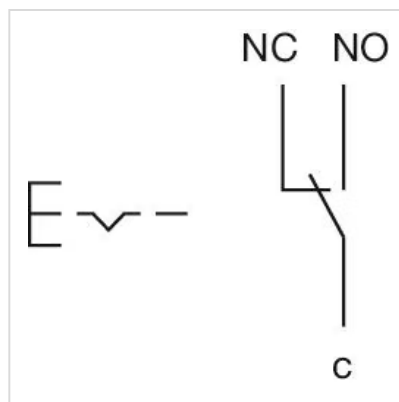

**Component layouts:**

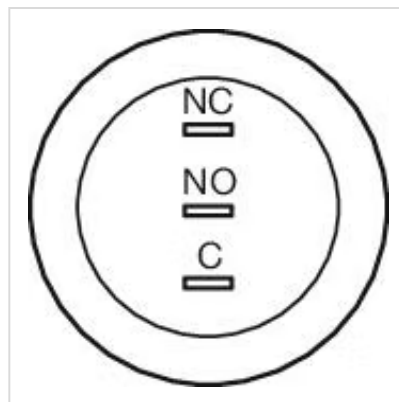

**Mounting cut-outs:**



**Dimension drawings:**

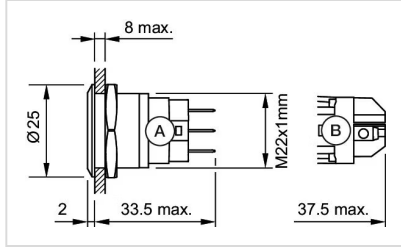

A = Solder terminal  
 B = Screw terminal