

# Actuator

92-  
440.000

Distribution by  
Mouser



<https://mouser.eao.com/component/92-440.000/e...>

Your product:

---



## 92-440.000 Actuator

*Loading ...*

### FRONT

|                              |                   |
|------------------------------|-------------------|
| <b>Front dimension:</b>      | 18,8 mm x 18,8 mm |
| <b>Front form:</b>           | Square            |
| <b>Front bezel colour:</b>   | Black             |
| <b>Front bezel material:</b> | Plastic           |

### MOUNTING

|                       |                |
|-----------------------|----------------|
| <b>Design:</b>        | PCB            |
| <b>Mounting type:</b> | Panel mounting |

### OPERATING-/INDICATION PART

|                           |             |
|---------------------------|-------------|
| <b>Lens illumination:</b> | Illuminated |
|---------------------------|-------------|

### ELECTRICAL CHARACTERISTICS

|   |                   |                                       |
|---|-------------------|---------------------------------------|
| <b>Switching voltage and switching current:</b> | Switching voltage | min. 50 m VAC/DC<br>max. 42 VAC/DC    |
|   | Switching current | min. 10 µA AC/DC<br>max. 100 mA AC/DC |
|   | Power rating      | max. 2 W                              |

|                          |      |
|--------------------------|------|
| <b>Switching rating:</b> | 42 V |
|--------------------------|------|

|                             |  |
|-----------------------------|--|
| <b>Electrical lifetime:</b> | 500 000 cycles of operation at 42VDC, 50mA, according to IEC 6512-5-9c |
|-----------------------------|--|

|                           |  |
|---------------------------|--|
| <b>Electric strength:</b> | 500 VAC, 50 Hz, 1 minute according to IEC 60512-5-9c |
|---------------------------|--|

|                                       |       |
|---------------------------------------|-------|
| <b>Electrostatic discharge (ESD):</b> | 15 kV |
|---------------------------------------|-------|

### MECHANICAL CHARACTERISTICS

|                             |   |
|-----------------------------|---|
| <b>Switching action:</b>    | Momentary   |
| <b>Switching system:</b>    | Short-travel element  |
| <b>Switching system:</b>    | Short-travel switching system with 2 independent contact points<br>Guarantees reliable switching even of very light loads. Fitted with 1 normally open contact. |
| <b>Mechanical lifetime:</b> | ≥1 Mil. cycles of operation   |
| <b>Operating force:</b>     | 2.7 N ±1 N switching element, 5 N lens  |
| <b>Operating Travel:</b>    | ca. 0.4 mm switching element  |
| <b>Tightening torque:</b>   | Fixing nut max. 0.5 Nm, Fixing screw mounting flange 0.4 Nm   |
| <b>Weight:</b>              | 0.017 kg  |

### AMBIENT CONDITION

|                               |  |
|-------------------------------|--|
| <b>IP front protection:</b>   | IP67   |
| <b>IP Protection:</b>         | IP67 front side  |
| <b>Operating temperature:</b> | - 25 °C ... + 70 °C  |
| <b>Storage temperature:</b>   | - 40 °C ... + 80 °C  |
| <b>Shock resistance:</b>      | Max. 500 m/s <sup>2</sup> , pulse width, 3-axis (sinusoidal EN IEC 60068-2-27)                     |
| <b>Vibration resistance:</b>  | Max. 100 m / s <sup>2</sup> from 10 Hz ... 500 Hz, 10 cycles, 3-axis (sinusoidal EN IEC 60068-2-6) |

### CERTIFICATE

|                      |   |
|----------------------|---|
| <b>Approbations:</b> | CQC   |
| <b>Conformities:</b> | CE, UKCA, 2011 / 65 / EC (RoHS), 2014 / 35 / EU (LVD) |
| <b>REACH:</b>        | REACH compliant                                       |
| <b>RoHS:</b>         | RoHS compliant  |

### OTHER

|                           |   |
|---------------------------|---|
| <b>Short Description:</b> | Actuator, 18,8 mm x 18,8 mm, Illuminated, Square, Black, Plastic, Momentary, IP67 |
| <b>Housing colour:</b>    | White   |
| <b>Housing material:</b>  | Plastic   |
| <b>Wiring diagrams:</b>   |   |

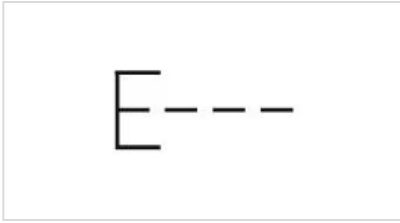

**Mounting cut-outs:**

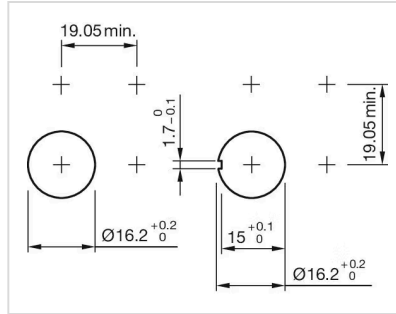

**Dimension drawings:**

